

**CODICE:** 8.220.0509      **REV.:** |      **DESCRIZIONE:** APOLLO IF-03 220-240/50 (KRA50LT KRUGER)

**DATA INIZIO VAL.:** 03/16/2012      **DATA FINE VAL.:** 01/01/3000

**CODICE GRUPPO:** R82200509      **REV.:** |      **DESCRIZIONE:** APOLLO IF-03 220-240/50 (KRA50LT KRUGER)

**DATA INIZIO VAL.:** 03/16/2012      **DATA FINE VAL.:** 01/01/3000      **N. TAVOLA:** E8220C001/01

<b>CODICE:</b>	<b>DESCRIZIONE:</b>	<b>QTA':</b>	<b>POS:</b>	<b>RIF1:</b>	<b>RIF2:</b>
4.208.0268	BLACK HEAD FOR VACUUM CLEANER APOLLO ESP.00	1	02		
4.208.0001	HANDLE SEAT FOR VACUUM CLEANER	1	03		
4.208.0398	CONVEYOR -GR- RAL.7046 X APOLLO	1	05		
3.755.0069	UNIVERSAL MOTOR 230V/50HZ	1	10		
6.205.0072	SEAL KIT	1	11		
5.211.0003	LOWER BLACK CALOTTE	1	12		
4.208.0283	HANDLE FOR VACUUM CLEANER '03 (DARK GREY RAL.7016)	1	17		
4.208.0302	VACUUM HEAD FOR ZEUS'03	1	18		
5.009.0293	RED BACKLIGHTED SWITCH WITH PR OTECTOR	1	19		
4.208.0135	CONE TO EXTEND THE FILTER FOR V.C.'03 (BLACK)	1	20		
5.209.0052	CLOTH FILTER + RING x ZEUS	1	21		
3.751.0013	INOX DRUM FOR ZEUS AISI 430BA ESP.00	1	22		
6.205.0071	KIT GASKET+PIPE UNION FOR PROF ESSIONAL VACCUM	1	24		
3.006.0058	WHEEL PIV. D.60 H82 M10x20 XEC O VERSION (A122211TGN)	2	25		
4.208.0286	ZEUS BASE '03 (DARK GREY 7016)	1	26		
6.205.0075	KIT OUTLET PIPE	1	28		
4.207.0027	STEEL HANDLE FOR APOLLO	1	29		
4.207.0005	WHEELS AXLE FOR ZEUS-DOMUS-TAU RUS D.15 L.490	1	40		
4.207.0025	REED FOR NO STATIC ELECT. KIT	1	45		
4.208.0397	ADAPTOR COVER FOR ZEUS DRUM -GREY-	1	46		
4.215.0019	GASKET 348x382 5mm=sp. x ZEUS	1	47		
4.012.0142	NO DISTURBANCE FILTER MOD.AV. 1.40.00 MKTx2,22mF K275V	1	48		
4.215.0061	DIVIDING SPONGE FOR ZEUS HEAD sp.30	1	50		
5.211.0003	LOWER BLACK CALOTTE	1	53		
6.205.0069	KIT WHEELS FOR TAURUS/DOMUS/ZE US/APOLLO	2	54		
4.012.0197	CABLE H05VV-F 2X0.75MT.10 F/F SCHUKO PLUG ESP.00	1	55		
3.099.0454	HOOK 2.05/621 ZNT FOR BODY TAURUS '03	2	56		
5.009.0213	SWITCH WITH PROTECTION 12(10)	1	58		
4.208.0101	DETERGENT TANK	1	59		
4.608.0027	CAP DIAM.30 FOR TANK FIRE 100	1	60		
6.205.0053	KIT SUCTION WATER FILTER + PLASTIC CONNECTION	1	61		
3.752.0173	PUMP ULKA 28W EP8 230/50 CS M7589	1	63		
6.205.0076	KIT PLUG+COUPLINGS (APOLLO/COSTELLATION)	1	64		
4.212.0020	CABLE AWM 1015 16AWG 105Gr L=500 + NO STATIC ELECT.SYSTEM	1	66		
3.403.0148	THERMOSTAT UP62 130'C	1	67		

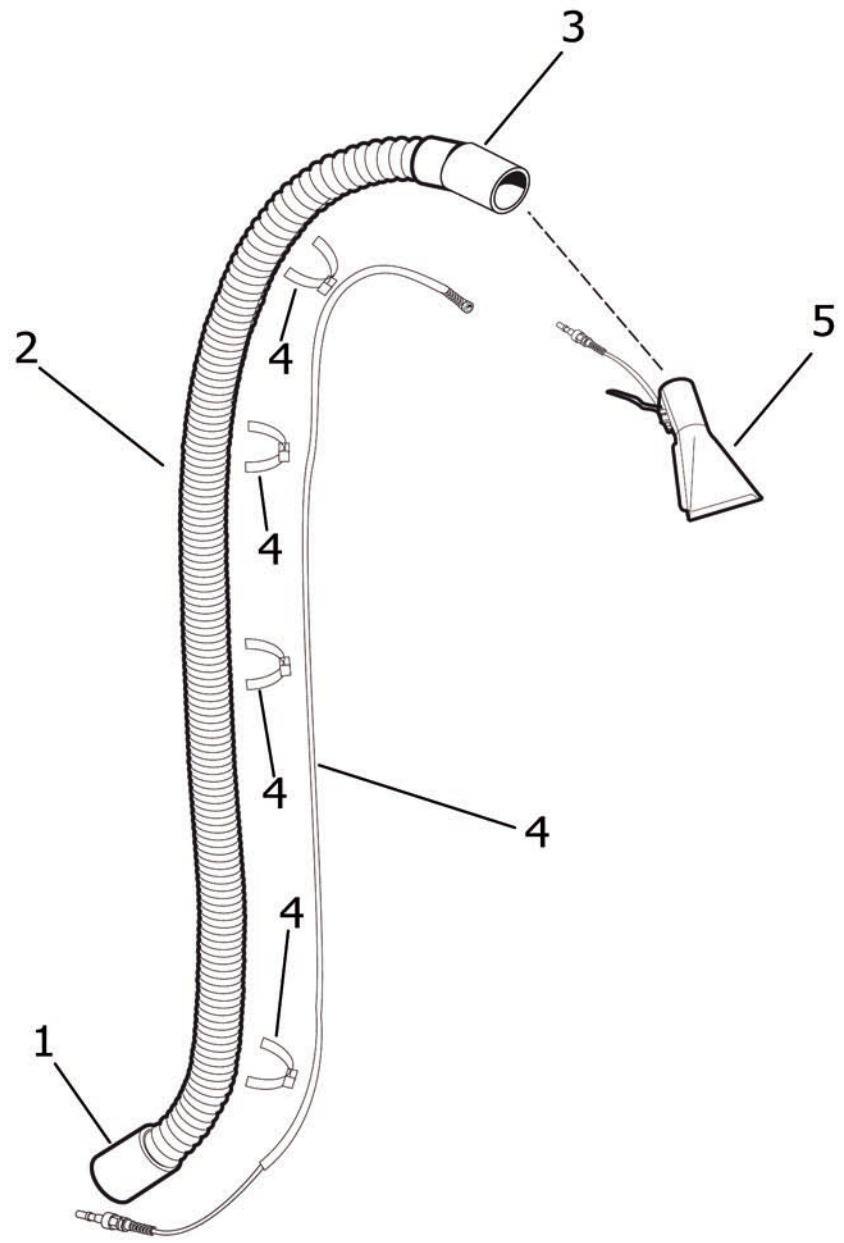

**LISTA RICAMBI****CODICE:** 8.220.0509      **REV.:** |      **DESCRIZIONE:** APOLLO IF-03 220-240/50 (KRA50LT KRUGER)**DATA INIZIO VAL.:** 03/16/2012      **DATA FINE VAL.:** 01/01/3000**CODICE GRUPPO:** R8220A509      **REV.:** |      **DESCRIZIONE:** ACCESSORIES**DATA INIZIO VAL.:** 03/16/2012      **DATA FINE VAL.:** 01/01/3000      **N. TAVOLA:** E8221A001/05

<b>CODICE:</b>	<b>DESCRIZIONE:</b>	<b>QTA':</b>	<b>POS:</b>	<b>RIF1:</b>	<b>RIF2:</b>
3.754.0047	COUPLING FOR FLEX HOSE (TANK SIDE) D. 40	1	01		
3.752.0076	FLEX TUBE MT.2,40 D.40	1	02		
3.754.0046	COUPLING FOR FLEX HOSE (ACCESSORY SIDE) D.40	1	03		
5.211.0084	KIT INJ./EXTR. W/OUT TAP	1	04		
5.209.0143	SMALL INJ./EXTR. NOZZLE	1	05		