

KRÜGER
Technology S.L.

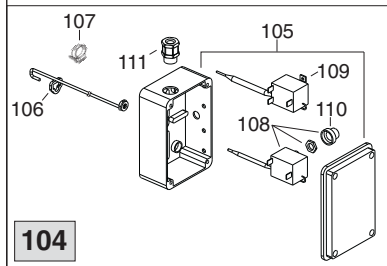

104

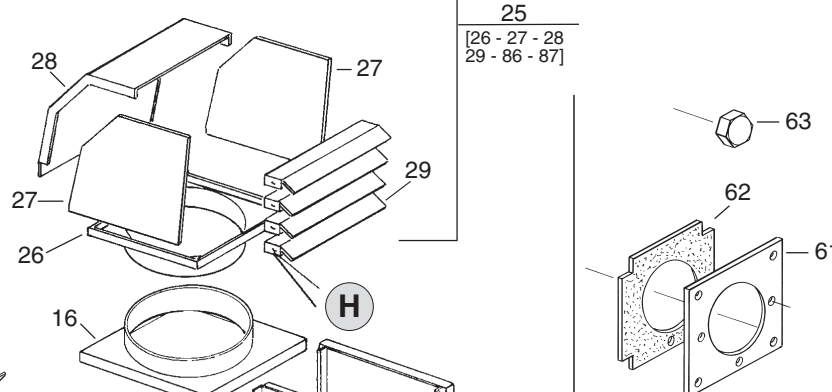

25
[26 - 27 - 28
29 - 86 - 87]

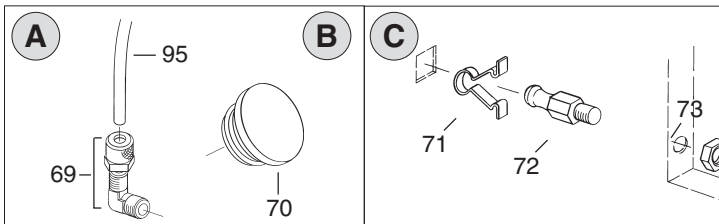
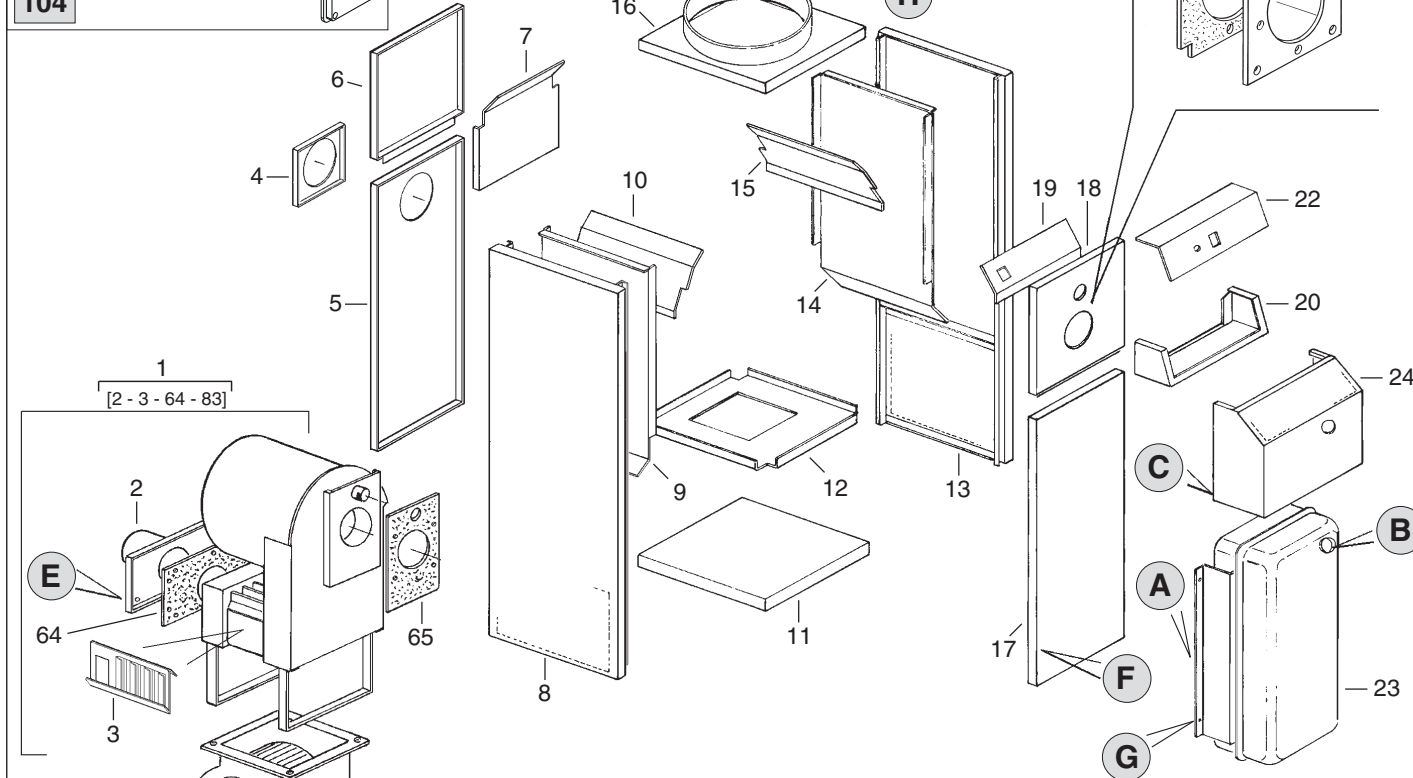

NERTA 34

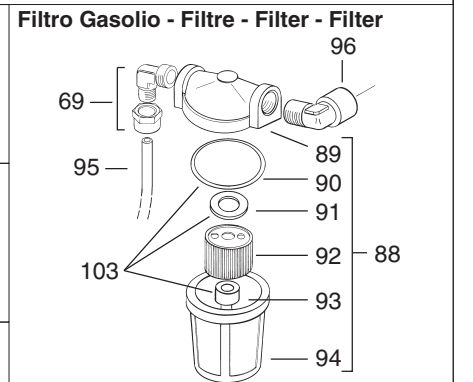
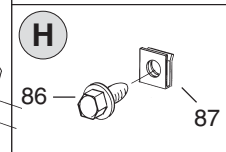
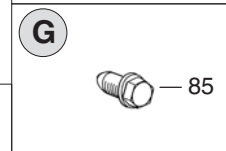
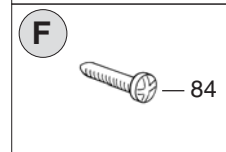
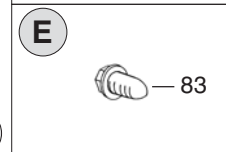
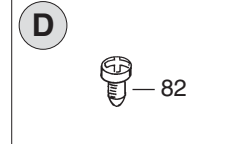
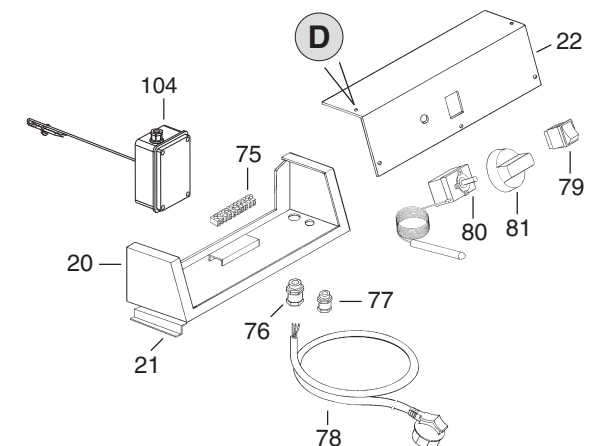

Optional Filtro Gasolio con preriscaldamento
Filtre pre-chauffage - Heizölvorwärmfilter
Oil pre-heaters filter

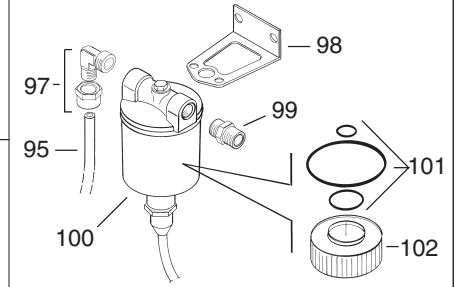

Da matr. N. - De matr. No. - Von Masch. Nr. - From number:

NERTA 34

65102101

Pos.	Cod.	€	NERTA 34	LEGENDA	LEGENDE	NOMENKLATUR	PART LIST
1	G01120 G01121		•	Camera combustione	Chambre de combustion	Brennkammer	Combustion chamber
2	G01150 G01151		•	Sportello ispezione	Porte visite	Inspectionklappe	Inspection door
3	G01850 G01856		•	Turbolenziatore	Turbulateur	Verwirbelungsplatte	Baffle plate
4	G01131-Y		•	Flangia camino Ø 150	Bride cheminée Ø 150	Ø 150 Rauchfang Flansch	Chimney flange Ø 150
5	G01142-Y G01143-Y		•	Pannello camino	Panneau cheminée	Rauchfang Platte	Chimney panel
6	G01144-Y G01145-Y		•	Pannello posteriore superiore	Panneau côte cheminée superieur	Obere Beplankung Kamin Seite	Upper rear panel
7	G01209 G01210		•	Convogliatore posteriore	Défecteur d'air posterieur	Hintere Luftleitblech	Rear conveyor
8	G01341-Y G01390-Y		•	Pannello laterale sinistro	Panneau lateral gauche	Seiten Beplankung links	Left side panel
9	G01205 G01206		•	Pannello interno sinistro	Panneau interieur gauche	Untere Beplankung links	Left inner panel
10	G01207 G01208		•	Deflettore laterale sinistro	Défecteur d'air gauche	Luftleitblech links	Left side deflector
11	G01947-Y G01948-Y		•	Basamento	Base	Kastenträger	Base
12	G01215 G01216		•	Pannello ventilatore	Panneau ventilateur	Ventilator Platte	Fan panel
13	G01340-Y G01389-Y		•	Pannello laterale destro	Panneau lateral droite	Rechtseitige Beplankung	Right side panel
14	G01211 G01212		•	Pannello interno destro	Panneau interieur droite	Untere Beplankung rechts	Right inner panel
15	G01213 G01214		•	Deflettore laterale destro	Défecteur d'air droite	Luftleitblech rechts	Right side deflector
16	G01664-Y G01391-Y		•	Pannello superiore	Panneau superieur	Obere Beplankung	Upper panel
17	G01126-Y G01127-Y		•	Pannello anteriore inferiore	Panneau frontal inferieur	Vondere Beplankung unten	Bottom front panel
18	G01128-1-Y G01129-1-Y		•	Pannello bruciatore	Panneau brûleur	Brenner Platte	Burner panel
19	G01217-1 G01218-1		•	Convogliatore anteriore	Défecteur d'air anterieur	Luftleitblech vorne	Front conveyor
20	G01953-1-Y G01954-1-Y		•	Supporto quadro elettrico	Support coffret électrique	Elektrokastenhalterung	Electrical drawer support
22	G01955-Y G01956-Y		•	Coperchio quadro el.	Couvercle	Deckplatte	Cover
23	G01426		•	Serbatoio	Réservoir fuel	Tank	Fuel tank
24	G01957-Y G01958-Y		•	Carter bruciatore Minor	Carter brûleur Minor	Abdeckblech seitlich Brenner Minor	Burner casing Minor
	G05127-Y G05128-Y		•	Carter bruciatore Max	Carter brûleur Max	Abdeckblech seitlich Brenner Max	Burner casing Max
25	G01959-Y G01960-Y		•	Pannello inferiore carter	Panneau inférieur carter	Untere Tafel der Schutzabdeckung	Tank casing lower panel
26	G01351-Y G01962-Y		•	Fianchetto carter sinistro	Flanc gauche carter	Seitenwand der Schutzabdeckung links	Burner casing SX cover
27	G01350-Y G01961-Y		•	Fianchetto carter destro	Flanc droite carter	Seitenwand der Schutzabdeckung rechts	Burner casing DX cover
28	G01398-Y G01399-Y		•	Testata diffusione aria 4 vie	Culasse diffusion d'air à 4 voies	4-Wege-Luftverteilungseinheit	4-Ways air out let
29	G01963-Y		•	Fianchetto testata aria	Flanc culasse d'air	Seitenwand Luftenheit	Air outlet lateral panel
30	G01964-Y		•	Aletta corta 383mm	Ailette courte	Kurzer Flügel 383 mm	Short louvre 383 mm
	G01965-Y		•	Aletta corta 473mm	Ailette courte	Kurzer Flügel 473 mm	Short louvre 473 mm

Da matr. N. - De matr. No. - Von Masch. Nr. - From number:

NERTA 34

65102101

Pos.	Cod.	€	NERTA 34	LEGENDA	LEGENDE	NOMENKLATUR	PART LIST
31	G01965-Y G01966-Y G01967-Y G01968-Y		•	Aletta lunga 473mm Aletta lunga 573mm	Ailette longue Ailette longue	Langer Flügel 473 mm Langer Flügel 573 mm	Long louvre 473 mm Long louvre 573 mm
32			•	Pannello superiore testata	Panneau supérieur culasse	Obere Tafel Kopfeinheit	Air outlet upper panel
61	G01098		•	Piastra bruciatore	Support brûleur	Brennerflansch	Burner support
62	T10602		•	Guarnizione isolante	Joint isolant	Isolation Dichtung	Thermal insulation
63	I25001		•	Tappo ferro	Bouchon fer	Propfen	Female plug
64	T10612 T10613		•	Guarnizione isolante	Joint isolant	Isolation Dichtung	Thermal insulation
65	T10614			Guarnizione isolante	Joint isolant	Isolation Dichtung	Thermal insulation
66	CG001 CG002		•	Ventilatore DD 10/8 Ventilatore DD 12/9	Ventilateur DD 10/8 Ventilateur DD 12/9	Ventilator DD 10/8 Ventilator DD 12/9	Fan DD 10/8 Fan DD 12/9
67	CG003 CG004		•	Motore	Moteur	Motor	Motor
68	E11203 E11208		•	Condensatore µF 10 Condensatore µF 20	Condensateur µF 10 Condensateur µF 20	Kondensator µF 10 Kondensator µF 20	Condenser µF 10 Condenser µF 20
69	I20410		•	Raccordo 90° 1/4"Mx8	Raccord 90° 1/4"Mx8	Eckanschluss s 90° 1/4"Mx8	Connection 90° 1/4"Mx8
70	I31018		•	Tappo riempimento	Bouchon de remplissage	Filtergehäuse	Tank plug
71	M20410		•	Chiusura 1/4 di giro	Fermeture 1/4 de tour	Schließung 1/4 Umdrehung	Screw 1/4
75	E20302		•	Morsettiere 12 el. mmq 6	Barrette de connection 12 el. mmq 6	Klemme 12 el. mmq 6	Terminal board 12 el. mmq 6
76	E20913		•	Pressacavo PG11	Presse câble PG11	Kabelführung PG11	Cable fastener PG 11
77	E20918		•	Pressacavo PG 9	Presse câble PG 9	Kabelführung PG 9	Cable fastener PG 9
78	E30419		•	Cavo elettrico	Cable électrique	Elektro kabel	Power cord
79	E10102		•	Commutatore	Commutateur	Schalter	Control knob
80	CG015		•	Termostato	Thermostat	Thermostat	Thermostat
81	C10314		•	Manopola completa	Bouton thermostat complet	Thermostat Schalter	Thermostat knob complete
82	M10508		•	Vite autofilettante TC 8x3/8"	Vis TC 8x3/8"	Schraube TC 8x3/8"	Screw TC 8x3/8"
83	M10511		•	Vite autofilettante TE 14x5/8" FR	Vis TE 14x5/8" FR	Schraube TE 14x5/8" FR	Screw TE 14x5/8" FR
84	M10515		•	Vite autofilettante TC 8x1"	Vis TC 8x1"	Schraube TC 8x1"	Screw TC 8x1"
86	M10510		•	Vite autofilettante TE 10x1/2" FR	Vis TE 10x1/2" FR	Schraube TE 10x1/2" FR	Screw TE 10x1/2" FR
87	M20402		•	Piastrina	Ecrou	Mutter	Nut
88	T20201		•	Filtro	Filtre	Filter	Filter
89	T20205		•	Coperchio filtro	Couvercle filtre	Filterhaube	Filter cover
90	T20202		•	OR	OR	OR	OR
91	T20214		•	Guarnizione	Joint	Dichtung	Seal
92	T20206		•	Cartuccia filtro	Cartouche filtre	Filterelement	Filter cartridge
93	T20213		•	Guarnizione Inferiore	Joint inferieur	Untere Oelfilterdichtung	Lower filter
94	T20212		•	Bicchiera filtro	Cuve filtre	Filtergehäuse	Filter housing
95	I40306		•	Tubo rilsan Ø 8	Tuyau Rilsan Ø 8	Rilsan Rohr Ø 8	Rilsan pipe Ø 8
96	I20301		•	Gomito 1/4" G 1/4" M-F	Raccord 90°G 1/4" M-F	Eckansch luss 90°G 1/4" M-F	Connection 90°G 1/4" M-F
97	I20412		•	Raccordo 90° 3/8"Mx8	Raccord 90°3/8"Mx8	Eckanschluss 90°3/8"Mx8	Connection 90°3/8"Mx8
98	T20224		•	Supporto filtro	Support	Stütze	Filter support
99	I20103		•	Nipplo FE 3/8"M-1/4"M	Raccord 3/8"- 1/4"	Nippel 3/8"- 1/4"	Nipple 3/8"- 1/4"
100	T20209		•	Filtro gasolio c/preriscaldamento 3/8"	Filtre pre-chauffage 3/8"	Heizölvorwärmfilter 3/8"	Oil pre-heaters filter 3/8"
101	T20231		•	Kit OR filtro	KIT OR	KIT OR	OR KIT filter
102	T20230		•	Cartuccia filtro	Cartouche filtre	Filterelement	Filter cartridge
103	T20234		•	Kit OR filtro	KIT OR	KIT OR	OR KIT filter
104	G00233		•	Termostato completo	Thermostat	Thermostat	Thermostat
105	E20719-05		•	Scatola der.	Coffret électrique	Kontrollkasten	El. components box
106	P30170		•	Bacchetta portabulbi	Porte-Bulbes	Kugelironträger	Bulbs holder
107	C30712		•	Fascetta serraggio	Collier	Klemme	Clip
108	E50745		•	Termostato TY95H 105 °C Campini	Thermostat TY95H 105 °C Campini	Thermostat TY95H 105 °C Campini	Thermosta t TY95H 105 °C Campini
109	E50747		•	Termostato TY95 0/60 °C Campini	Thermostat TY95 0/60 °C Campini	Thermostat TY95 0/60 °C Campini	Thermosta t TY95 0/60 °C Campini
110	E50750		•	Protezione per Termostato sicurezza	Protection pour thermostat de sécurité	Sicherheitsthermostatschutz	Safety thermostat plastic profile
111	E20918		•	Pressacavo PG 9	Presse étoupe PG 9	Kabelpresse PG 9	Cable fastener PG 9